

Henningson, Durham &
Ruffalo
Engineering, P.C. In Association
with HDR Engineering, Inc.

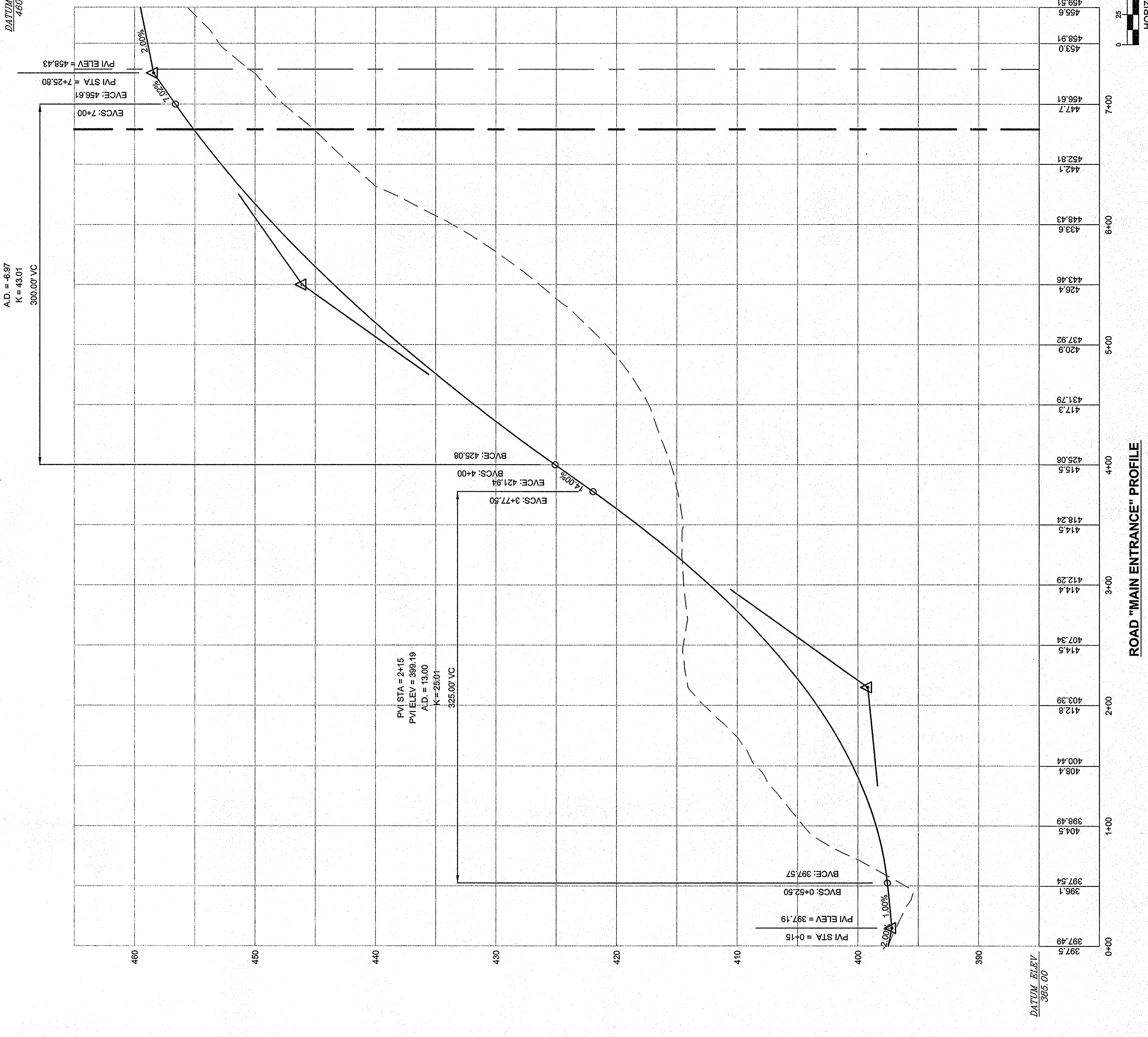
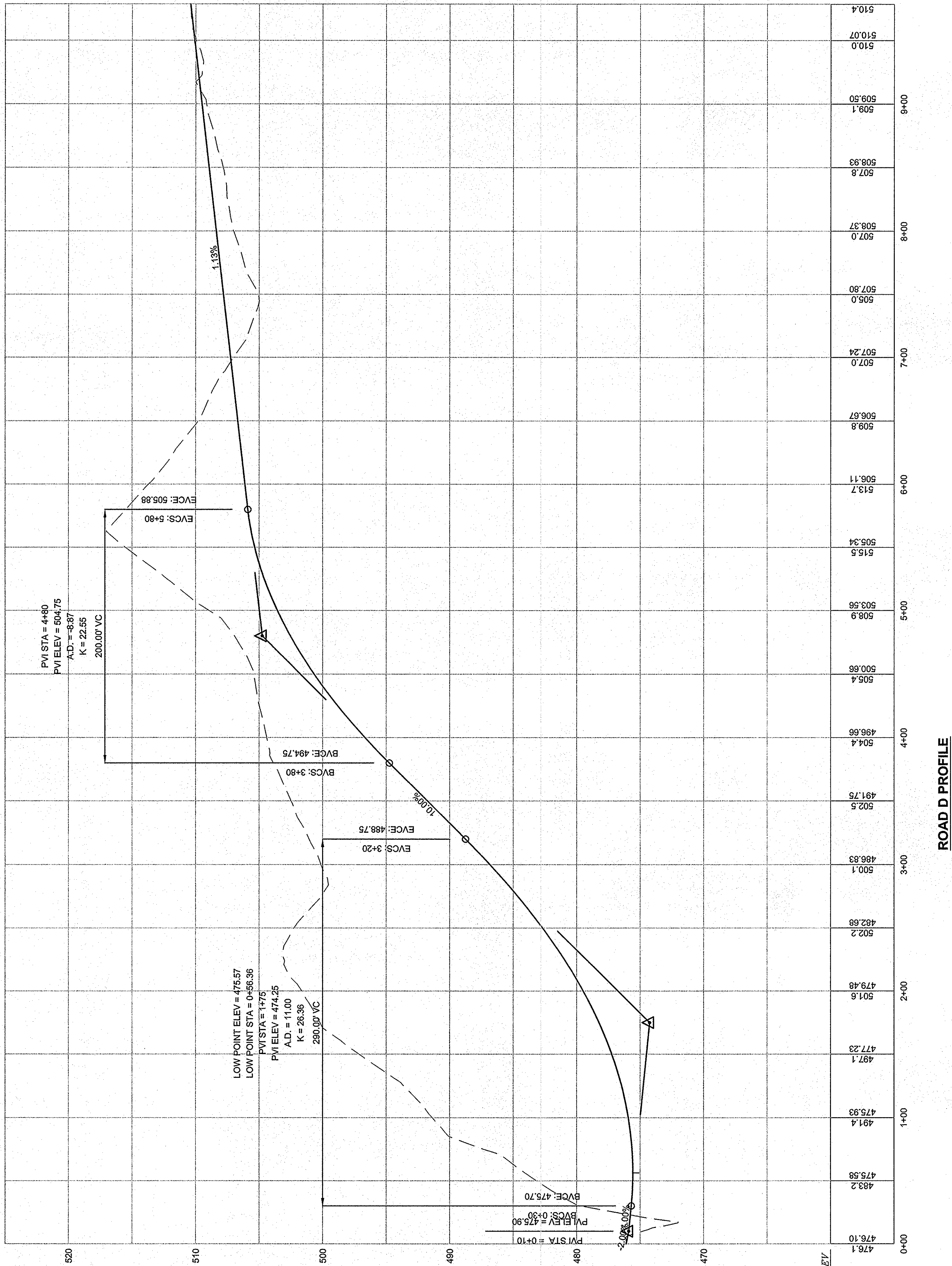
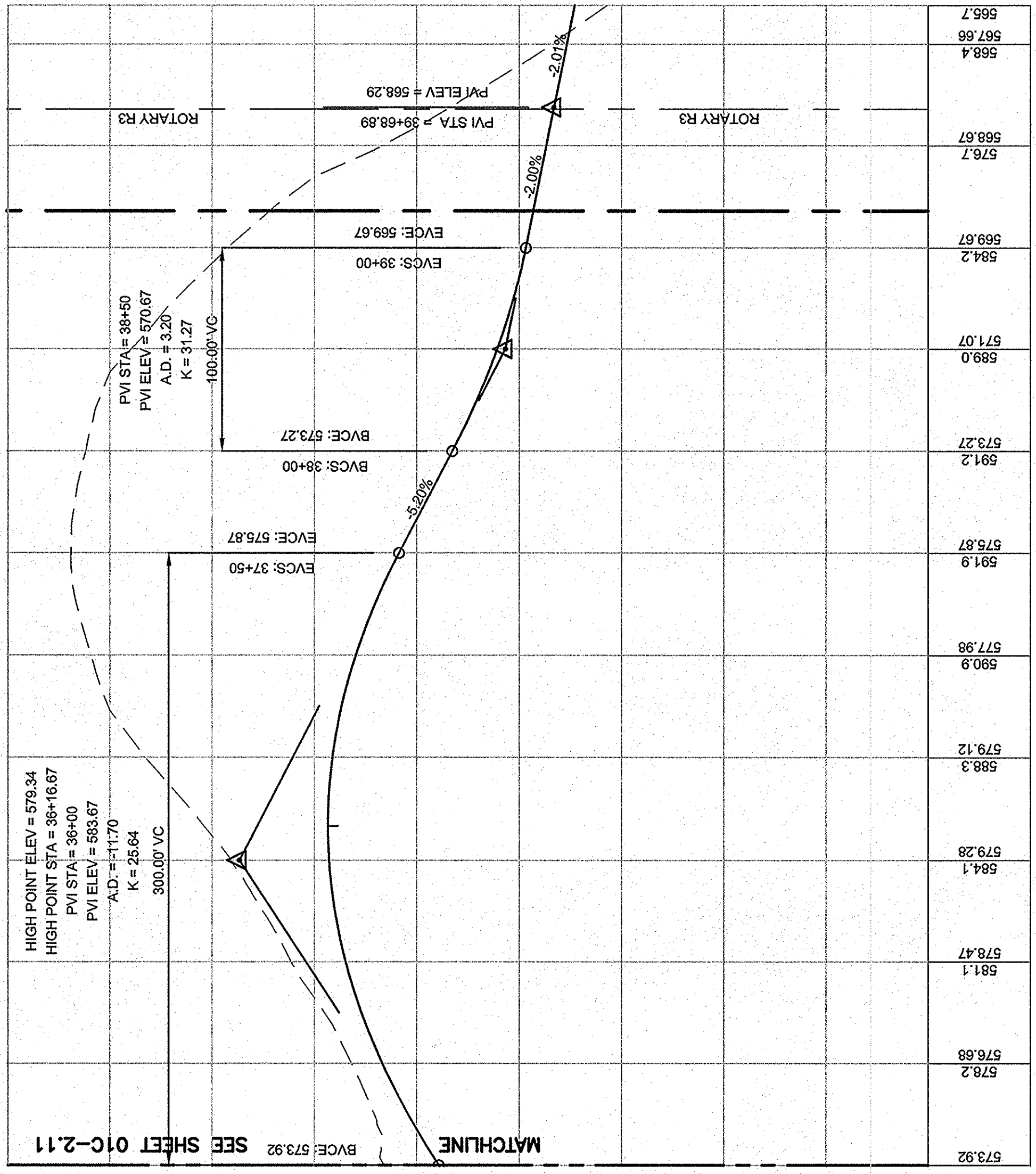

Millennium Homes
Legacy Ridge
FEIS Submittal
Town of Woodbury,
Orange County, New York

ISSUE	DATE	DESCRIPTION
0	08/20/2007	FEIS SUBMISSION

PROJECT NUMBER: 00137-65305
PROJECT MANAGER: S. BUEHNER, P.E.

SIGNATURE: _____ DATE: _____
WARNING: It is a violation of the New York State Education Law for any person who is not a duly licensed professional engineer to seal any plan or these drawings. Any such seal or signature on these drawings shall be deemed to be made in accordance with the provisions of the Education Law.

**ROAD C STA 34+50 TO 40+19.08
ROAD D AND
"MAIN ENTRANCE" PROFILE**

SCALE: 1"=50' (HORZ), 1"=5' (VERT)
01C-2.14
FILENAME: 01C-2.14